

Waterproof housing

The waterproof sealing system guarantees protection of the bearing from the external environment

Inspectable bearing

The clip-on protection cover can be removed for bearing inspection

Locking by grub screws

The bearing can be locked onto the shaft by grub screws

ISO dimensions

The overall dimensions can be interchanged with the corresponding cast iron type bearings

Series UCFC/C

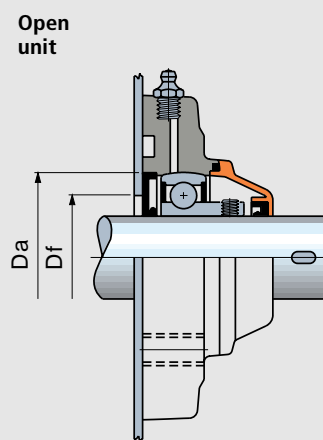
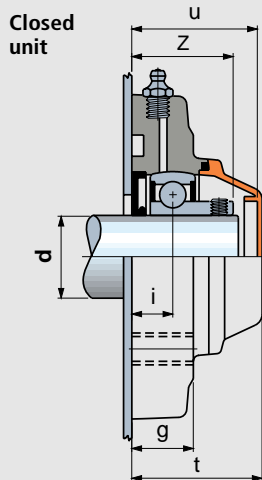
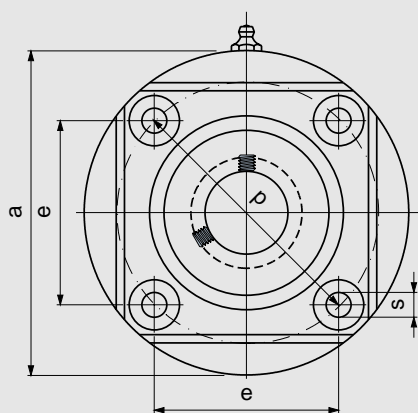

Shaft dia. d mm	Bearing type	Code		Dimensions in mm										Bore in frame ¹⁾			Weight Kg	Application characteristics
		Closed unit	Open unit	e	a	p	s	g	i	z	u	t	Da	Df max	Df min	Bearing		
PA FV polyamide housing																		
35	UCFC 207 C	683921	683931	77,8	137	110	11	26	17,3	42,7	53	55	72	70	55	YAT 207 2	0,75	<ul style="list-style-type: none"> • High mechanical and heat resistance • Proof to dust, humidity, washouts, steam, average aggressive chemical agents
PP FV polypropylene housing																		
35	UCFC 207 C	62239	62249	77,8	137	110	11	26	17,3	42,7	53	55	72	70	55	YAT 207 2	0,75	<ul style="list-style-type: none"> • Proof to highly aggressive chemical agents

1) = Dimensions Df max / Df min must be respected to ensure positive retention of the seals and to allow air bleeding during lubrication.

YAT 2 Bearing

Chrome alloy steel • Grub screws shaft locking • Supergriseal unit • Prelubricated with lithium / calcium grease • Can be relubricated • Self aligning within 2° max
Dimensions and characteristics at page 38-39.

PA FV polyamide housing

Housing in reinforced polyamide PA FV resin (black)
• Protection cover in reinforced polypropylene PP FV (orange) • Seal and O-Ring in NBR rubber • Ball type nickel plated brass greasing nipple • Reinforcing bushings on mounting holes and washers in stainless steel AISI 304

PP FV polypropylene housing

Housing in reinforced polypropylene PP FV resin (black)
• Protection cover in reinforced polypropylene PP FV (orange) • Seal and O-Ring in Viton rubber • Ball type stainless steel AISI 316 greasing nipple • Reinforcing bushings on mounting holes and washers in stainless steel AISI 316

Shaft dia. d mm	Bearing type	Bearing load (N)			Bearing unit max. static load (N)				Continuous operating temperature (°C)			
		Load coefficient		Max. axial load ²⁾	Fr ↓		Fr ↓		in air		in hot water	
		dynamic C	static Co		PA FV	PP FV	PA FV	PP FV	PA FV	PP FV	PA FV	PP FV
35	UCFC 207 C	19600	15300	3920	17000	11000	20000	10000	- 20 a + 90	- 20 a + 70	80	100

2) = The grub screws blocking method allows a maximum axial load of: 0,20 • C (with non hardened shafts and grub screws tightened with recommended torsion couples). The radial static loads Fr have been established in laboratory conditions on housings complete with bearings.



Accessories / page 34

- Quick coupler for remote lubrication
- Grease nipple cover



Spare parts / page 35-36

- Closed or open protection cover
- Ball type greasing nipple
- Sealing ring (opposite side to protection cover)

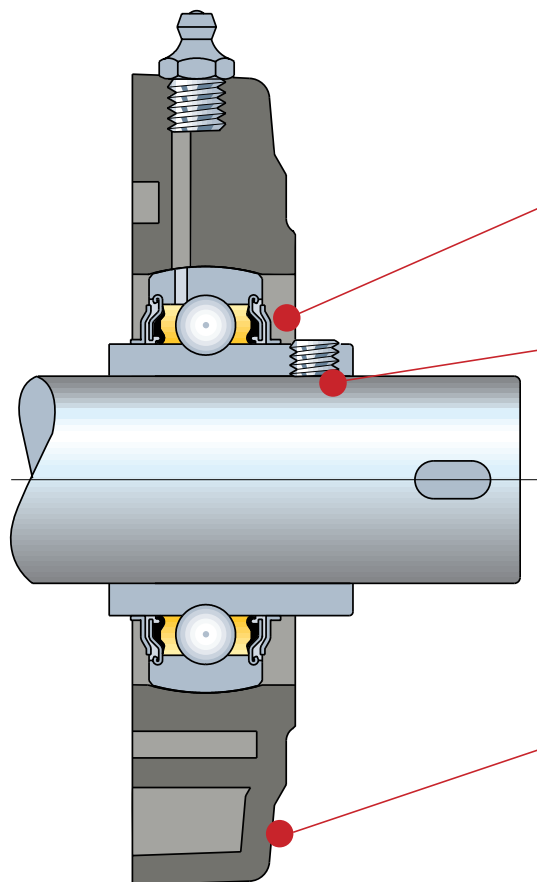

Moderate protection

The bearings feature Superagriseal unit plus centrifuging ring for guaranteed protection against dust and non corrosive agents. For critical applications use the version with stainless steel AISI 420 bearing

Locking by grub screws

The bearing can be locked onto the shaft by grub screws

Protection cover

It is supplied as an **optional accessory**. They are available in the closed or open version, they protect the bearing and avoid contact with the rotating shaft (personnel protection). Clip-on design. Can be removed and replaced at will.

ISO dimensions

The overall dimensions can be interchanged with the corresponding cast iron type bearings

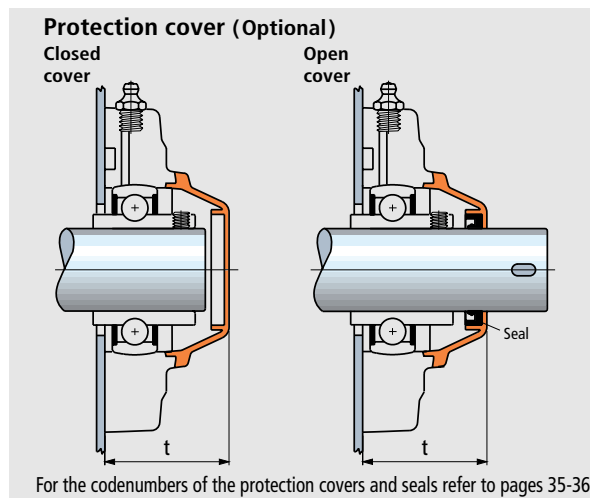
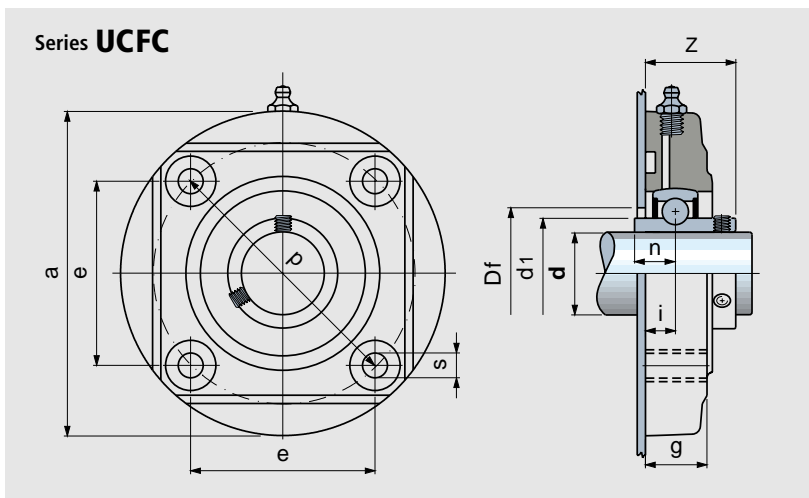

Shaft dia. d mm	Bearing type	Code	Dimensions in mm										Bore in frame Df min	Bearing	t	Weight Kg	Application characteristics
			Bearing	e	a	p	s	g	i	n	z	d1					
PA FV polyamide housing / steel bearing																	
35	UCFC 207	60752		77,8	137	110	11	26	12,3	17,5	37,7	46,1	50	YAR2072F	50	0,75	<ul style="list-style-type: none"> • High mechanical and heat resistance • Positive sealing capacity against dust, non corrosive agents
PP FV polypropylene housing / stainless steel AISI 420 bearing																	
35	UCFC 207	699381		77,8	137	110	11	26	12,3	17,5	37,7	46,1	50	YAR2072RF/HV	50	0,75	<ul style="list-style-type: none"> • Positive sealing capacity against humidity, vapours, salty environments, slightly corrosive chemical agents

YAR 2F - YAR 2RF/HV bearings

Shaft locking by grub screws
 • Superagriseal units plus centrifuging ring (steel version)
 • Superagriseal units plus rubberised centrifuging ring (stainless steel version)
 • Prelubricated with lithium / calcium grease
 • Can be relubricated
 • Self aligning within 2.5° max
 Dimensions and characteristics at page 38-39.

PA FV polyamide housing

Housing in reinforced polyamide PA FV resin (black)
 • Chrome alloy steel bearing
 • Ball type nickel plated brass greasing nipple
 • Reinforcing bushings on mounting holes and washers in stainless steel AISI 304

PP FV polypropylene housing

Housing in reinforced polypropylene PP FV resin (black)
 • Stainless steel AISI 420 bearing
 • Ball type stainless steel AISI 316 greasing nipple
 • Reinforcing bushings on mounting holes and washers in stainless steel AISI 316

Protection cover

Covers are supplied without seals. To increase protection it is recommended to use them with seals unit (supplied separately).
 • Cover in reinforced polypropylene PP FV (orange)
 • Seal in NBR rubber (for PA FV support) / in Viton rubber (for PP FV support)
 • Different colours on request

Shaft dia. d mm	Bearing type	Bearing load (N)			Bearing unit max. static load (N)				Continuous operating temperature (°C)			
		Load coefficient		Max. axial load ²⁾	Fr ↓		Fr ↓		in air		in hot water	
		dynamic C	static Co		PA FV	PP FV	PA FV	PP FV	PA FV	PP FV	PA FV	PP FV
35	UCFC 207	19600 (16600)	15300 (15300)	3920 (3320)	17000	11000	20000	10000	- 20 a + 90	- 20 a + 70	80	100

Do not use steam for cleaning

Bracketed figures refer to stainless steel bearings.
 2) = The grub screws blocking method allows a maximum axial load of: 0,20 • C (with non hardened shafts and grub screws tightened with recommended torsion couples).
 The radial static loads Fr have been established in laboratory conditions on housings complete with bearings.



Accessories / page 34

- Quick coupler for remote lubrication
- Grease nipple cover



Spare parts / page 35-36

- Ball type grease nipple
- Closed or open protection cover
- Seal for protection cover

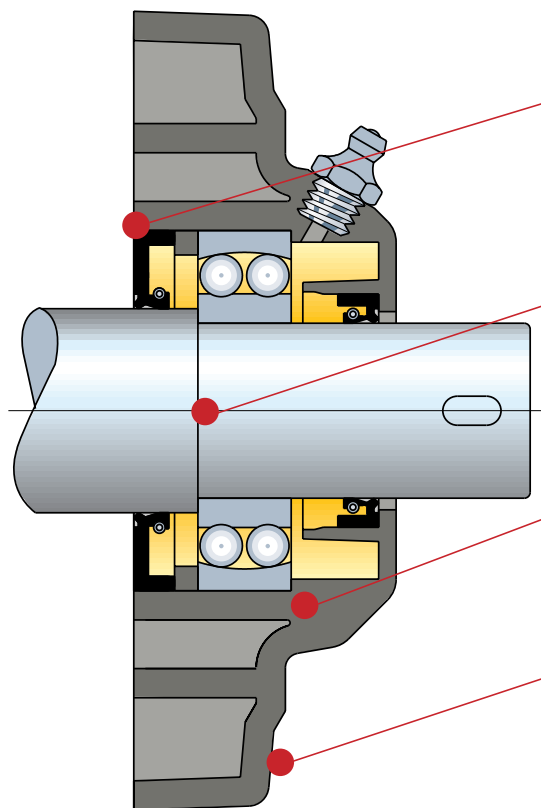

Waterproof housing

The waterproof sealing system guarantees protection of the bearing from the external environment

Shaft shoulders locking

The unit features a self aligning ball bearing held into position by the shaft shoulders

High axial load capacity

The shaft shoulders/flange allow higher axial load

ISO dimensions

The overall dimensions can be interchanged with the corresponding cast iron type bearings

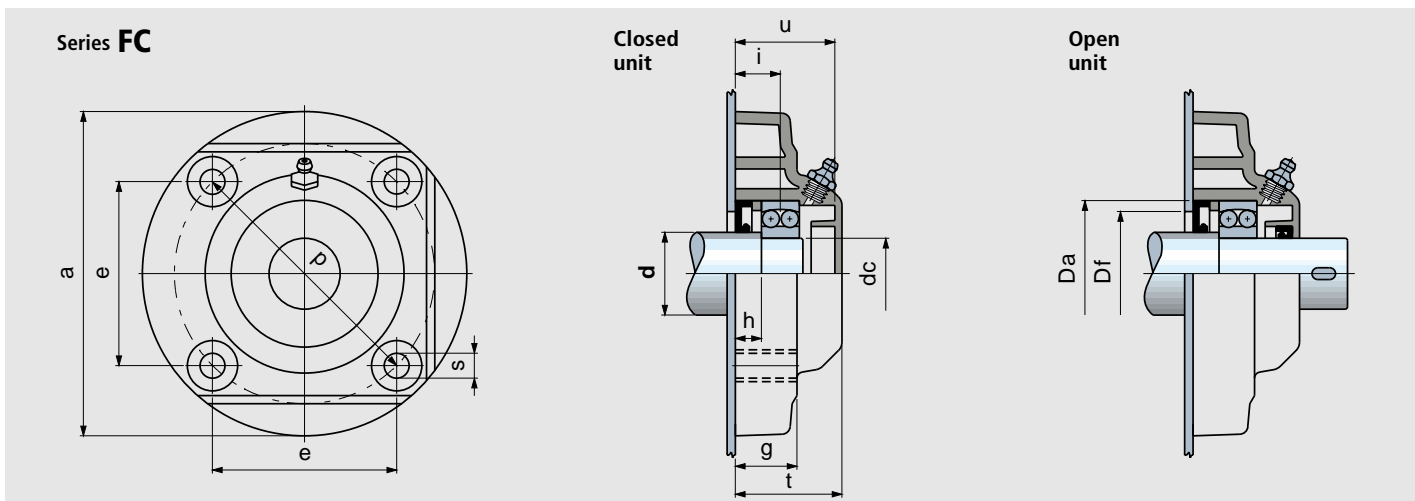

Shaft dia. d mm	Bearing housing dia. dc mm	Bearing type	Code		Dimensions in mm										Bore in frame ¹⁾ Df		Weight Kg	Application characteristics	
			Closed unit	Open unit	e	a	p	s	g	i	h	u	t	Da	max	min			Bearing
PA FV polyamide housing																			
35	30	FC 1206	65801	65891	77,8	137	110	11	26	19	11	39	45	62	60	52	1206	0,57	<ul style="list-style-type: none"> • High mechanical and heat resistance • Proof to dust, humidity, washouts, steam, average aggressive chemical agents
PP FV polypropylene housing																			
35	30	FC 1206	61972	62002	77,8	137	110	11	26	19	11	39	45	62	60	52	1206	0,57	<ul style="list-style-type: none"> • Proof to highly aggressive chemical agents

1) = Dimensions Df max / Df min must be respected to ensure positive retention of the seals and to allow air bleeding during lubrication.

1200 series bearing

Chrome alloy steel • Self aligning ball bearing
 • Supplied without grease • To be prelubricated with lithium / calcium grease during first installation
 • Selfaligning within 2°
 Dimensions and characteristics at page 39.

PA FV polyamide housing

Housing in reinforced polyamide PA FV resin (black)
 • Seal in NBR rubber • Ball type nickel plated brass greasing nipple • Reinforcing bushings on mounting holes and washers in stainless steel AISI 304

PP FV polypropylene housing

Housing in reinforced polypropylene PP FV resin (black)
 • Seal in Viton rubber • Ball type stainless steel AISI 316 greasing nipple • Reinforcing bushings on mounting holes and washers in stainless steel AISI 316

Shaft dia. d mm	Bearing housing dia. dc mm	Bearing type	Bearing load (N)		Bearing unit max. static load (N)					Continuous operating temperature (°C)				
			Load coefficient		Fr ↓		Fr ↓		Fa →	in air		in hot water		
			dynamic C	static Co	PA FV	PP FV	PA FV	PP FV	PA FV	PP FV	PA FV	PP FV	PA FV	PP FV
35	30	FC 1206	15600	4650	15000	10000	15000	10000	20000	11000	- 20 a + 90	- 20 a + 70	80	100
													Do not use steam for cleaning	

The radial static loads Fr and the axial static loads Fa have been established in laboratory conditions on housings complete with bearings.



Accessories / page 34

- Quick coupler for remote lubrication
- Grease nipple cover



Spare parts / page 35-36

- Ball type grease nipple
- Sealing ring (opposite side to protection cover)